



BSL12N-7/BSL16N-7

# ELECTRIC STACKER

1.2 & 1.6 ton capacity



## BSL12/16N-7

### Highlights



#### 1 Electronic proportional lifting and lowering

- The electronically controlled proportional lifting system ensures precise positioning and stacking at any lifting height.
- In specific circumstances where a high mast is required, electronically controlled proportional lifting performs at its best.



#### 2 Long tiller arm design

- The operator can always maintain a safe distance from the truck while working.
- The driver must apply less force on the long tiller arm than on a forklift truck with a shorter tiller arm.
- The working height of the tiller arm is naturally positioned in an ergonomic, user-friendly operating position.
- Stacking can be done more ergonomically and faster due to the safe distance and better visibility of the forks.
- The 4-wheel design with side mounted tiller arm gives an exact and perfect view of the forks.



#### 3 Maintenance friendly

- The design of the trucks and the components used are tailored to make service and maintenance easy.
- All parts are easy accessible when the main cover is removed with 2 screws. The drive wheel and the castor wheel are easy to exchange without craning the truck.



#### 4 CANBUS technology

- Thanks to less wiring, the CANBUS is more reliable.
- CANBUS technology makes analysis and adjustments easier, so that the downtime is low.
- Digital signals make parts longer lasting.



#### 5 German AC drive technology

- The powerful maintenance-free AC drive motor in combination with the gearbox, break and drive wheel gives the best performance, efficiency and reliability to reduce operating costs.
- Whether smooth or fast acceleration is applied, the AC drive always gives the right and direct response.



#### 6 Robust and reliable design

- The robust chassis with the strong 8 mm thick apron protects the truck and its components against external mechanical shocks.
- In combination with the metal battery cover, the truck is well equipped to keep maintenance and damage to a minimum.
- Dirty environments have less influence on the vertical design of the AC motor design because the components and brake are outside the range of direct shocks.
- IP54 protected controller, safe against dust and splashing water.

## Your warehousing partner

The BSL12/16N-7 Series is tailored to most pedestrian-controlled stacking operations with capacities from 1,200 kg up to 1,600 kg.

The long mounted tiller arm keeps the operator safe and in an ergonomic position while working. The careful operation of the fully proportional lifting system makes stacking safer and quicker. Due to the high quality and advanced components and technologies of top brands, the truck competes with leading brands on the market.

### Top brand qualified components

- Reliable multifunctional REMA tiller with ergonomic contact less rocker- switches
- Top quality AC drive motor
- Zapi controller

The used parts reduce service costs and give you the performance and reliability which is required for demanding stacking operations.

MAIN SPECIFICATIONS				
Model			BSL12N-7	BSL16N-7
Max. capacity	kg		1,200	1,600
Overall length	mm	l1	1,919	1,964
Distance between fork arms	mm	b5	570/685	
Fork dimensions	mm	s/e/l	60/180/1,150	
Turning radius	mm	Wa	1,440	1,510
Service weight	kg		1,007	1,340
Extended mast height	mm	h4	up to 5,080	up to 5,780
Lift height	mm	h3	up to 4,530	up to 5,230
Travel speed (loaded/unloaded)	km/h		6.0/6.0	5.7/6.0
Lift speed (loaded/unloaded)	m/s		0.10/0.17	0.13/0.20
Lowering speed (loaded/unloaded)	m/s		0.11/0.11	0.20/0.14
Max. gradability (loaded/unloaded)	%		6/12	

- Ergonomic, compact and safe long tiller arm design
- Precise lifting and lowering with fully proportional hydraulic system
- Powerful, maintenance free German AC power train
- Core components from top quality brands
- 4-wheel structure for stability

### Options

- Various mast versions

### For every application the right battery capacity

- BSL12N-7 with 150/172/200 Ah 2PzB battery  
Short truck length, good maneuverability and great for operating in limited spaces.
- BSL16N-7 with 255/258/300 Ah 3PzB battery

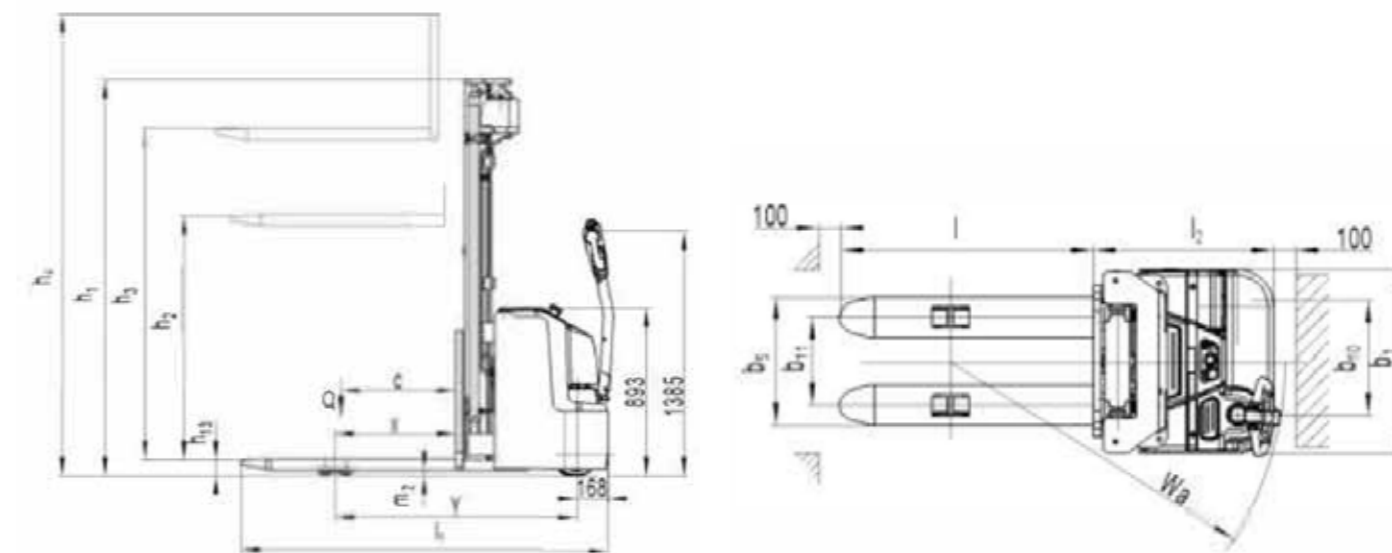

MAST SPECIFICATIONS					
	Lowered mast height mm - h1	Free lift height mm - h2	Lift height mm - h3	Extended mast height mm - h4	Lift + fork height mm - h3 + h13
<b>BSL12N-7</b>					
STD	1,958	-	2,830	3,380	2,920
	2,108	-	3,130	3,680	3,220
	2,308	-	3,530	4,080	3,620
FFL	2,108	1,560	3,130	3,680	3,220
	2,308	1,760	3,530	4,080	3,620
FFT	1,908	1,320	3,930	4,480	4,020
	2,008	1,420	4,230	4,780	4,320
	2,108	1,520	4,530	5,080	4,620
<b>BSL16N-7</b>					
STD	1,958	-	2,830	3,380	2,920
	2,108	-	3,130	3,680	3,220
	2,308	-	3,530	4,080	3,620
FFL	2,108	1,560	3,130	3,680	3,220
	2,308	1,760	3,530	4,080	3,620
FFT	1,708	1,120	3,330	3,880	3,420
	1,908	1,320	3,930	4,480	4,020
	2,008	1,420	4,230	4,780	4,320
	2,108	1,520	4,530	5,080	4,620
	2,343	1,756	5,230	5,780	5,320



Doosan Industrial Vehicle Europe nv  
 Europark-Noord 36A  
 9100 Sint-Niklaas  
 Belgium  
 Tel.: +32 3 760 09 87  
 Fax: +32 3 760 09 89  
 Website: www.doosan-iv.eu

Authorized Dealer